

# TURNY®

Makes it easier to enter  
and exit your car



For high-sill vehicles such as  
MPVs, SUVs, mini-buses or vans

 **auto**<sup>®</sup>  
**ADAPT**  
for your independence

INVENTIONS FOR QUALITY OF LIFE

# TURNY® HD

- with manual swivelling and electrically operated lifting and lowering!

TURNY HD swivels the car seat out through the door opening and lowers it to the correct position for comfortable transfer to or from a wheelchair. It offers manual swivelling and electrically operated lifting and lowering with a manual control. A wireless remote control is available as an optional extra and the lowering end stop is programmable.

TURNY HD is available in two lifting heights (300 and 395 mm) adapted to a variety of car types and user needs. This product is suitable for high-sill vehicles such as MPVs, SUVs, mini-buses and vans.

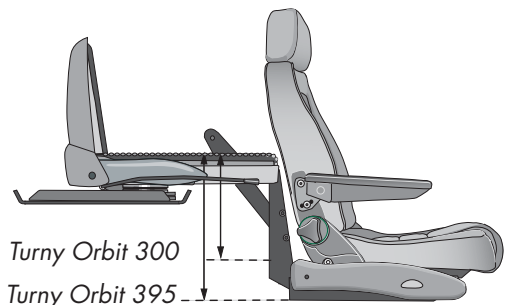

Turny HD fitted with the BEV-seat (an optional extra).



## Colour options

The Turny covers are available in two colour options:

**Grey**, as shown in the pictures to the left and

**Tan**, as in picture below.



TURNY HD can be installed in the passenger seat or the central row at the rear and provides a safe means of transport for the mobility-impaired, as the original three-point car belt is retained.

To save space, installation is recommended with a low-level car seat such as the BEV, which is easily adapted to the user's special needs and offers a wide range of practical accessories to ensure maximum seating comfort.

The product is installed in the original car-seat mounts in the floor, which in the majority of cases causes no damage to the vehicle, and it can also be transferred when necessary to another vehicle.

TURNY HD is CE- and E-marked and approved for a lifting capacity of 150 kg. It has also been subjected to crash, tensile and load tests.

Turny HD and Turny Orbit are operated with a manual control. A remote control is available as an optional extra.



TURNY HD has electrically operated lifting and lowering, while inward and outward swivelling is done manually by lifting the release lever by the side of the car seat.

# TURNY<sup>®</sup> Orbit

- electrically operated rotation, lifting and lowering.



1. Take hold of the manual control.



2. Press the button on the manual control to swivel the seat outwards.



3. Lower to the required height.



4. Release the button and the motion stops.



5. Turny Orbit functions as an excellent aid to standing up.

The major difference between TURNY Orbit and TURNY HD is that the former has fully electrically operated swivelling, lowering and lifting. This product allows passengers to handle inward and outward swivelling themselves, using a manual control, or permit somebody else to control this operation.

TURNY Orbit is available in two lifting heights of 300 and 395 mm and is suitable for high-sill vehicles such as MPVs, SUVs, mini-buses and vans. The lowering end stop is programmable. This product is CE- and E-marked, has an approved lifting capacity of 150 kg and all the practical benefits of the TURNY HD.



CE labeling is a guarantee that company products meet the requirements of the EU directive on medical aids.

*Lateral transfer from a wheelchair to Turny Orbit, installed here on the front passenger position in a minibus.*



# TURNY® + CARONY®

Turny in combination with the unique Carony system from Autoadapt



## CARONY 12" fixed®

**CARONY Fixed** eliminates lifting by the attendant and simplifies transfer to and from the vehicle. A couple of simple hand movements allow a single person to transfer the chair and passenger from the wheelchair base to the passenger seat. This is done without any lifting and so avoids arm and back strain. The compact wheelchair base is stored in the trunk when not in use. CARONY Fixed is CE-marked.

CARONY Fixed is a specially designed CARONY model that is used in combination with the TURNY car seat lift. Its continuously adjustable lifting and lowering function allows it to dock with the CARONY Fixed base, which has a set standard height. The set of pictures below illustrates passenger transfer from a CARONY Fixed to a TURNY Orbit in a mini-bus.

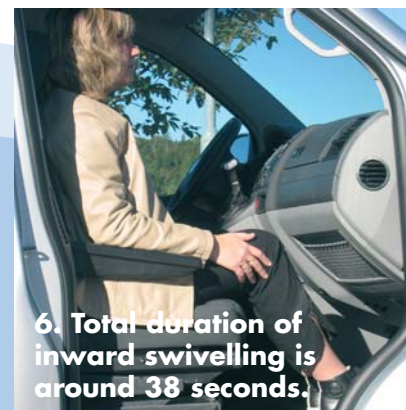
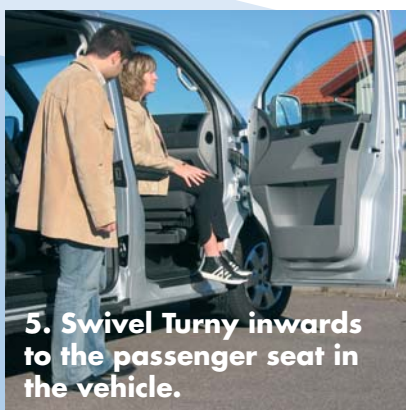

# TURNY® + CARONY® Kids

Carony Kids – a solution for families with children!



*Carony Kids is a transport wheelchair for children that facilitates transfer to a vehicle and is most suitably combined with either Turny HD or Turny Orbit in high-sill vehicles.*

## CARONY® Kids

**CARONY Kids** comprises a wheelchair base, a comfortable seat with adjustable neck rest and lumbar support, as well as a foot support that facilitates swivelling into and out of the vehicle. It is available in four different versions for Turny.

- With 12" rear wheels as a transport wheelchair
- With 24" wheels for children who can wheel the chair unaided
- With a CARONY Fixed base with a set standard height
- as a Kids seat without the Carony system



The seat is combined with the TURNY car seat lift. CARONY Kids eliminates lifting by an attendant and simplifies transfer to and from the vehicle.

CARONY Kids can be adapted to the child as cushion length can be set according to how much the child grows. The seat and rear cushions are washable and can be replaced if required. When the child has outgrown the chair it can be rebuilt as an adult chair following directions supplied by Autoadapt. CARONY Kids is CE-marked.

# TURNY® - accessories

## Protective bag for the belt cartridge

Art. No: 416093

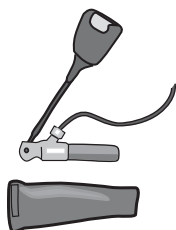

In most cases, the belt cartridge is located together with the original belt catch, whose use is recommended. The protective bag for the belt cartridge protects against external damage.

## Remote control

Art. No: 101144



## Template tool

Art. No: Right 100878  
Left 100888

There is a lightweight product model as an aid to making templates for Turny. It comprises a mounting plate and a swivel plate cut to the Turny's exact measurements and with the identical function so as to facilitate finding the location and measuring out the anchor points.

## Car seat rails



Art. No: 100505

Double-locked car seat rails to allow better adjustment of the seatback rake on the BEV or Recaro seat.

## Carony roller section

Art. No: Right 412119  
Left 412833

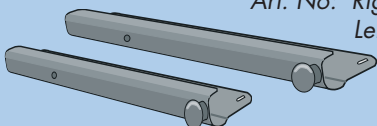

For Turny, only the 475 mm roller section is used.

## Protective bag for the sensor mat

Art. No: 415918

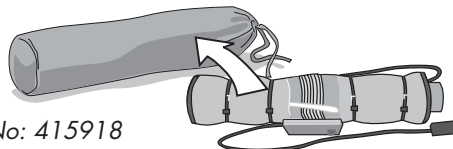

In certain vehicles, a mat with contacts is located beneath the seat cushion upholstery and detects whether the seat is occupied. This mat must be activated to retain airbag system functions after Turny is installed. The mat is therefore removed from the original seat, rolled up and placed in a protective bag. The mat connector is then re-connected to the car airbag system.

## Folding foot support

Art. No: 101292

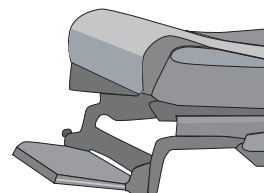

## Brand-adapted mounting brackets

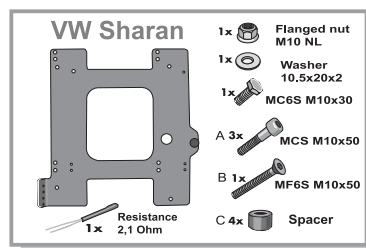

## Height-raising kit

Art. No: 100728, 70mm  
101227, 35 mm

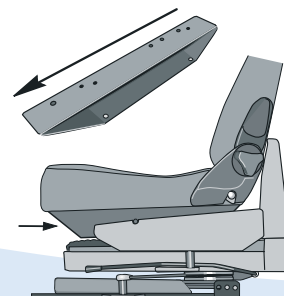

A car seat accessory in the Turny system.

On some vehicles the height of the original seat is so great that after installing Turny, it is necessary to raise the seat a bit to reach the correct seating level.

Turny should be installed as close to the floor as possible on account of its center of gravity. The kit should be installed between the car seat and Turny (also prepared for the Carony system).

# TURNY<sup>®</sup> Orbit - for commercial traffic

The TURNY Orbit is the perfect solution for taxicabs and community transport vehicles as it ensures safe transportation for the mobility-impaired as the original three-point car belts are used and the car seats can also be retained.

This product offers a simple way to assist passengers to exit and enter high-sill vehicles. It also facilitates the daily work of the drivers as no heavy and awkward lifting is required during use. Instead, the driver can control the entire process with a remote, as motion is electrically powered, with the focus entirely on the passenger.

TURNY Orbit has undergone crash tests and is approved for commercial use (for taxis and community transport vehicles), installed in the Volkswagen Transporter T5 and the Renault Espace 04. In the Transporter TURNY Orbit is approved on both the front passenger seat and on the right-hand side of the central row. The Renault Espace has an approval for TURNY Orbit and TURNY HD on the front passenger seat. Installation in the central row is not suitable on this model.



*Turny Orbit is easy to handle. The driver just pushes a button to ease the passenger into the vehicle. Here is the product installed on the right-hand side of the central row in a VW Transporter T5.*



*VW Transporter T5 with Turny installed on the front passenger seat.*

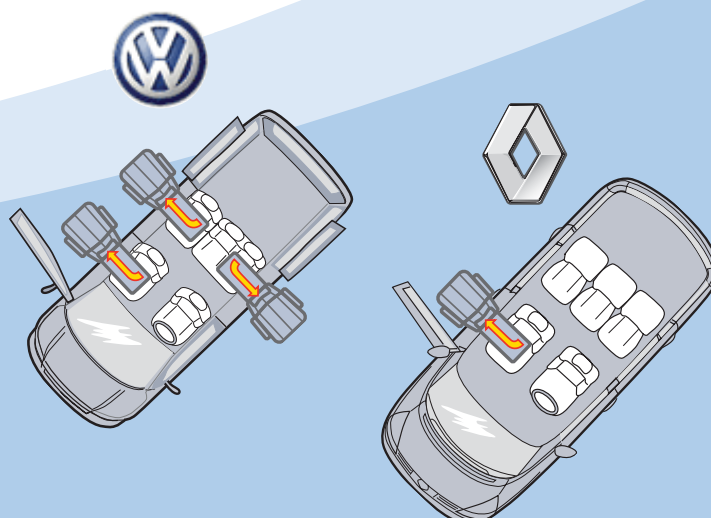

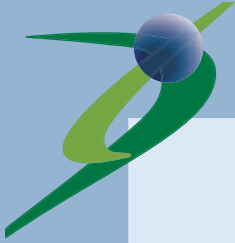

Crash test of a Turny Orbit in a Toyota Sienna.



	<b>Turny HD</b>	<b>Turny Orbit</b>
Vertical motion:	300 mm, 395 mm	300 mm, 395 mm
Installed height:	165 mm	165 mm
Maximum user weight:	150 kg	150 kg

Turny HD and Turny Orbit meet the current requirements specified in EU directives: 72/245/EEG to 95/54/EG, 74/60/EEG to 2000/4/EG, 74/408/EEG to 96/37/EG, 76/115/EEG to 96/38/EEG, 93/42/EEG, 95/28/EG, 89/392/EEG to 98/37/EG as well as ECE R-10, ECE R-14, ECE R-17 and also FMVSS 201, 207, 208, 209, 210 and 302.



Turny HD and Turny Orbit are E-marked, which indicates compliance with the United Nations global motor vehicle regulations. E-marking is a type approval and is issued in Sweden by the Swedish Road Administration.

For more information

[www.autoadapt.com](http://www.autoadapt.com)



**Autoadapt AB**

Hedeforsvägen 6, S-443 61 Stenkullen, Sweden  
 Phone: +46 302 558 20  
 E-mail: [contact@autoadapt.se](mailto:contact@autoadapt.se)  
[www.autoadapt.se](http://www.autoadapt.se)

**Autoadapt UK Ltd**

Unit 4 Windsor Industrial Estate Rupert Street, Aston B7 4, Birmingham UK  
 Phone: +44 (0)121 333 5170  
 E mail: [contact@autoadapt.co.uk](mailto:contact@autoadapt.co.uk)  
[www.autoadapt.co.uk](http://www.autoadapt.co.uk)

